

## Handle Assembly

1. Insert the bolt through the handle and the crank hole. Tighten the nylon-lock nut. Nuts need to be tightened to 15-20 ft-lbs.

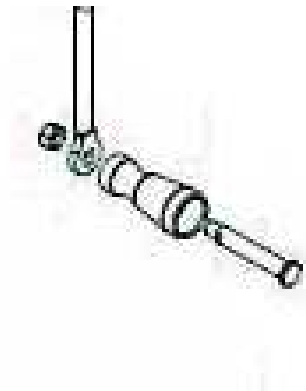

## Installation Instruction

1. Place jack against trailer frame and position the mounting bracket and straps in such a manner that the top holes are in line.
2. Insert mounting bolts: Two bolts on top of the trailer frame and two bolts below the trailer frame. Make sure the top mounting bolts rest directly on top of the trailer frame and the bottom bolts are as close to the trailer frame as possible.
3. Tighten lock-washers and nuts to mounting bolts. Nuts need to be tightened to 15-20 ft-lbs.

